

Write-Protect USB Source Creator



WP200TH

The WP200D is a write-protect USB maker that does not need to be connected to a computer and does not require complicated operations or data transfer requirements. With just one click, you can easily create a write-protect USB flash drive to replace the CD-ROMs and protect your data.



Stand-alone operation
No Computer required



One-click
production



Data
protection



Support W
Mode USBs

Source

You can use a regular FAT-formatted USB flash drive.

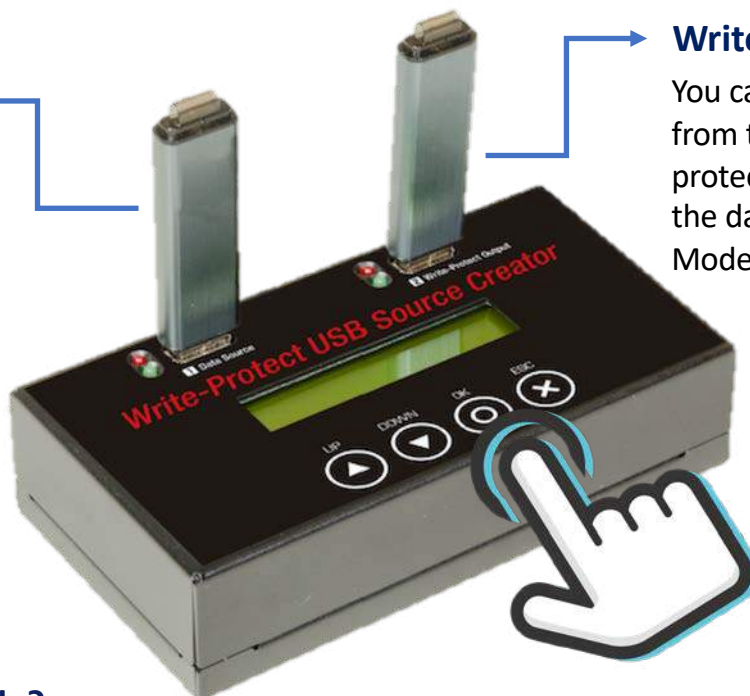

Write-Protect Target

You can transfer the data from the source to a write-protect USB stick and make the data undeletable. (A W Mode USB stick is required)

What is W Mode?

W Mode USB is a type of USB flash drive that works with special commands to enable write protection.

W Mode is used to identify whether a USB stick can be used to make write-protect USB sticks when copying.

Product Dimensions & Weight

Photo	Model	Targets	Product Size	Product Weight
	WP200TH	1	13.7 x 7.6 x 3.6 cm	0.57 kg

Basic Specifications

OS	Standalone, no computer required.
Language	English
LCD	Monochrome LCD
LED Indicators	2 LED Indicators per port. Green (Pass), and Red (Fail)
Control Buttons	4 buttons. (▲, ▼, OK, ESC)

Functions

Write-Protect Setting	1. Set Read Only 2. Copy + Read Only
Erase	Full Erase

Compatibility

Device Spec	USB3.0/2.0/1.1
Formats	FAT16/32, exFAT
OS Supported	All systems (Windows, Linux and others)

Hardware Specifications

DC Output (Power)	5V 2A		
Operating temperature	5°C ~ 45°C	Non-operating temperature	-20°C ~ 85°C
Operating Humidity	20% ~ 80%	Non-operating Humidity	5% ~ 95%

*Specifications are subject to change without further notice.